

# THE RUGER® BX-25™

This genuine Ruger® factory magazine has been tested and has proven to feed as reliably as the standard BX-1™ 10-round Ruger® rotary magazine.

BX-25™ magazines will work with any factory original Ruger® 10/22® Rifle, SR-22® Rifle, 22 Charger™ Pistol and 77/22® Rifle.

The BX-25™ will run reliably with a wide variety of ammunition. However, you may experience malfunctions (“jams”) when using subsonic ammunition or ammunition with heavy coatings of bullet lube. In some instances, cleaning the magazine may improve reliability, but in other cases you may need to switch to a different type or brand of ammunition to get the full use and enjoyment from your BX-25™ magazine. Please also be aware that some .22 LR magazine loaders are prone to damaging cartridges. If you experience stoppages while using magazines that were loaded using a magazine loader, please try loading the magazines by hand and determine if reliability improves.

The BX-25™ magazine requires no lubrication. If it becomes necessary to clean the magazine, loosen the screws on the right side of the magazine with a 3/32” hex tool. Next, separate the two halves, lifting the right side from the left side, and then lift out the spring, throat and follower from the left side. To reassemble the magazine, reverse the order of the disassembly instructions. Please see the diagram (right) for assistance. For detailed instructional videos and other information, please visit our website [WWW.RUGER.COM/BX-25](http://WWW.RUGER.COM/BX-25). Our Customer Service department may be reached at (603) 865-2442.

## GENUINE RUGER® FACTORY MAGAZINE

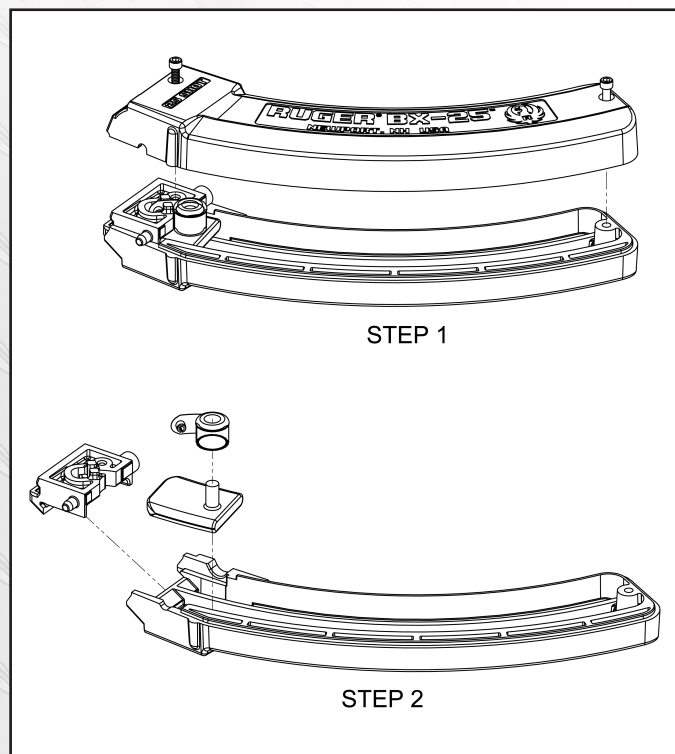

Other great firearms accessories are available at [WWW.SHOPRUGER.COM](http://WWW.SHOPRUGER.COM)

View the entire line of great firearms from Ruger at [WWW.RUGER.COM](http://WWW.RUGER.COM)

 **RUGER**  
[WWW.RUGER.COM/BX-25](http://WWW.RUGER.COM/BX-25)